

# FIVC Static Balancing Valve

Ductile Iron – PN 16 – Fixed Orifice – EN 1092-2



FSB series

## Technical data

### Main features and materials

- Body: Ductile Iron
- Bonnet: Ductile Iron
- Disc: Ductile Iron - EPDM
- Stem: Stainless Steel
- Handwheel: Ductile Iron
- Dimensions: Face-to-Face acc. to BS 7350:1990

### Field of applications

- Temperature range: -10 to 120°C
- Max. working pressure: 16 bar
- Accuracy of flow measurement: ±5%

- Petrochemical industry
- Irrigation systems
- Mining and infrastructure industries
- Shipyard industry
- Compressed air
- Textile industry
- Mechanical industry
- Other various industries

## Description

FIVC Static Balancing Valve is designed with integrated pressure probes to determine the flow rate through integrated fixed orifice. The valve controls hydraulic medium flow at HVAC plants and ensures load balance, hence contributes to energy and cost savings.

Further, the FIVC Balancing Valve does, through its reduction of media flow speed, prevents the water hammer phenomenon.

## Declaration

The product has been inspected and tested in accordance with the European PED Directive No 2014/68/EU, Schedule 4, Module H, dated 15/05/2014 and is CE marked.

## Dimensions

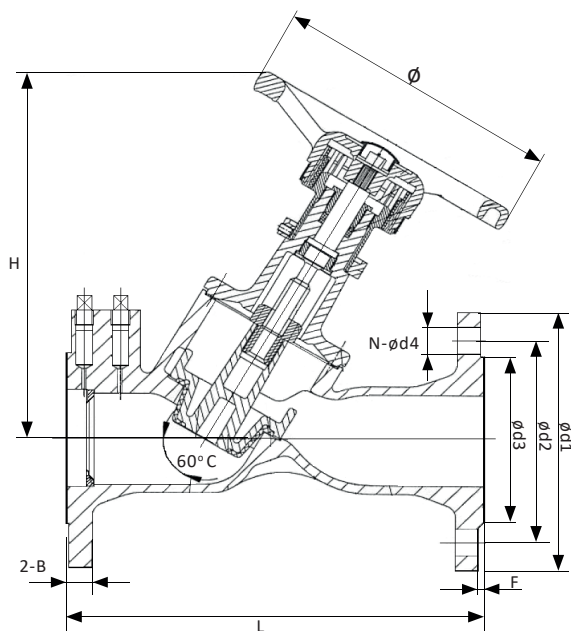

## Product Information

Product code	Size (DN)	H	L	B	Ø	Ød1	Ød2	Ød3	N-Ød4	F	Kg
FSB065N16GF230	65	263	290	19	200	185	145	118	4-Ø19	3	17
FSB080N16GF230	80	268	310	19	200	200	160	132	8-Ø19	3	20
FSB100N16GF230	100	300	350	19	240	220	180	156	8-Ø19	3	29
FSB125N16GF230	125	328	400	19	290	250	210	184	8-Ø19	3	40
FSB150N16GF230	150	340	480	19	290	285	240	211	8-Ø23	3	52
FSB200N16GF230	200	525	600	20	350	340	295	266	12-Ø23	3	113
FSB250N16GF230	250	572	730	22	420	405	355	319	12-Ø28	3	185
FSB300N16GF230	300	686	850	24.5	420	460	410	370	12-Ø28	4	248
FSB350N16GF230	350	681	980	26.5	420	520	470	429	16-Ø28	4	408
FSB400N16GF230	400	965	1100	28	640	580	525	480	16-Ø31	4	592
FSB450N16GF230	450	972	1200	30	640	640	585	548	20-Ø31	4	684
FSB500N16GF230	500	1065	1250	31.5	640	715	650	609	20-Ø34	4	836
FSB600N16GF230	600	1180	1450	36	640	840	770	720	20-Ø37	5	-

Dimensions are in millimeters

# FIVC Static Balancing Valve

Ductile Iron – PN 16 – Fixed Orifice – EN 1092-2

## Product Specification

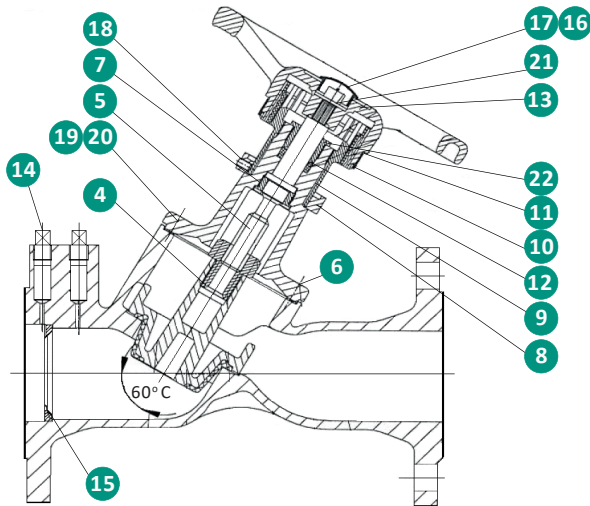

N°	Name	Material
1	Body	Ductile Iron EN JS 1040
2	Seal gasket	EPDM
3	Disc	Ductile Iron EN JS 1040+EPDM
4	Stem nut	Brass CW617N EN 12165
5	Stem	DN 65-300: Stainless Steel BS 970 410 S21 DN 350-600: Stainless Steel BS 970 431 S21
6	Cover	Ductile Iron EN JS 1040
7	Stem lock bushing	Brass CW617N EN 12165
8	Limit set of indicator	Stainless Steel BS 970 304 S15
9	Oriented set of indicator	Brass CW617N EN 12165
10	Directed circle	ABS plastic
11	Indicator	ABS plastic
12	Packing	PTFE+EPDM
13	Handwheel	Ductile Iron EN JS 1040
14	Plug	Brass C36000
15	Orifice insert	DN 65-300: Brass CW617N EN 12165 DN350-600: Stainless Steel BS 970 304 S15
16	Bolt	Stainless Steel BS 970 304 S15
17	Big gasket	Stainless Steel BS 970 304 S15
18	Hexagon socket screws	Stainless Steel BS 970 304 S15
19	Bolt	Stainless Steel BS 970 304 S15
20	Spring gasket	Stainless Steel BS 970 304 S15
21	Indicator dust cover	ABS plastic
22	Packing gland	DN 65-150: Brass CW617N EN 12165 DN 200-600: Ductile Iron EN JS 1040

# FIVC Static Balancing Valve

Ductile Iron – PN 16 – Fixed Orifice – EN 1092-2

## Flow Measurement Graphs

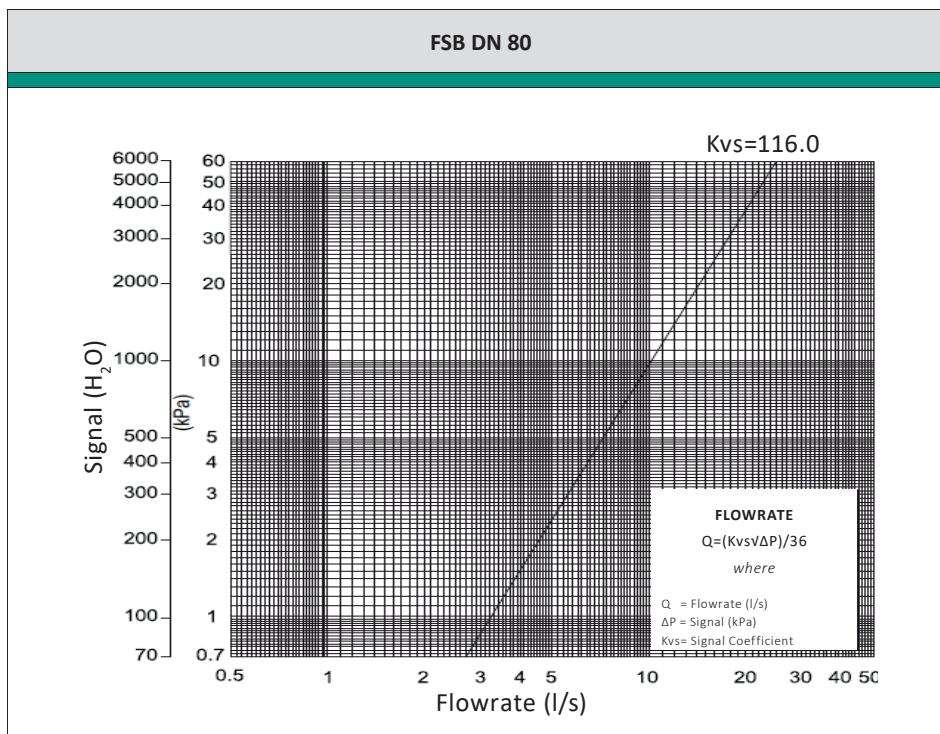
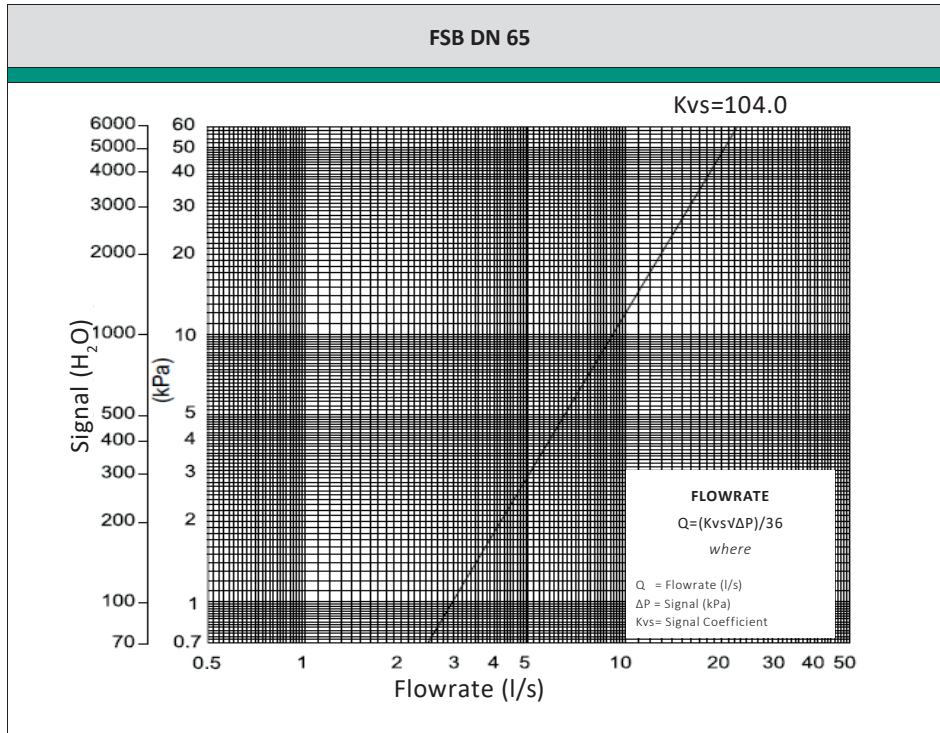

# FIVC Static Balancing Valve

Ductile Iron – PN 16 – Fixed Orifice – EN 1092-2

## Flow Measurement Graphs

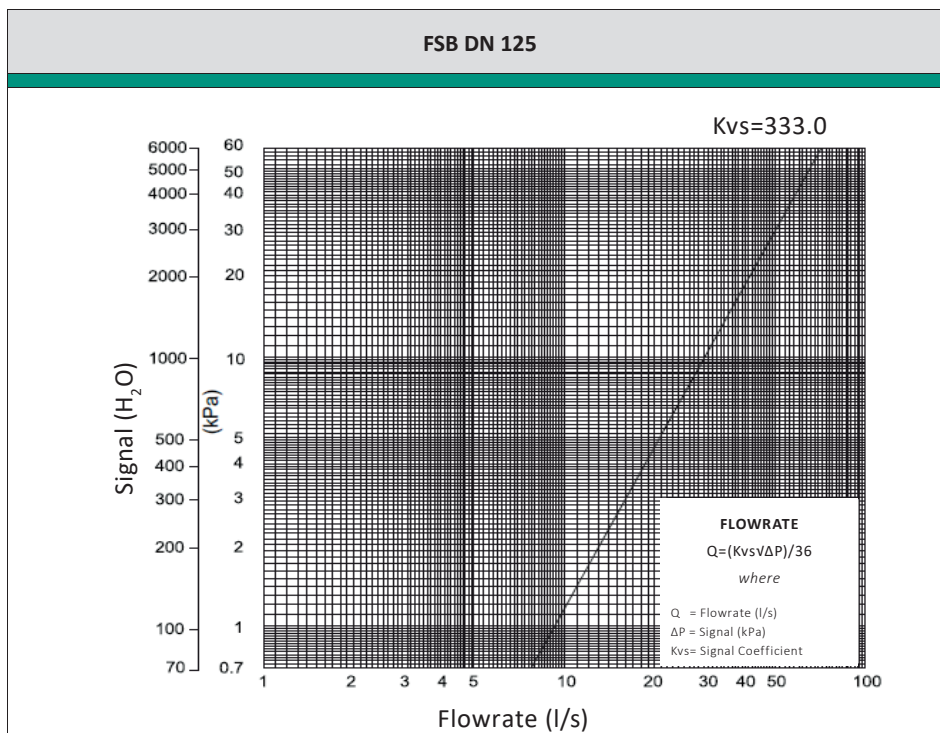
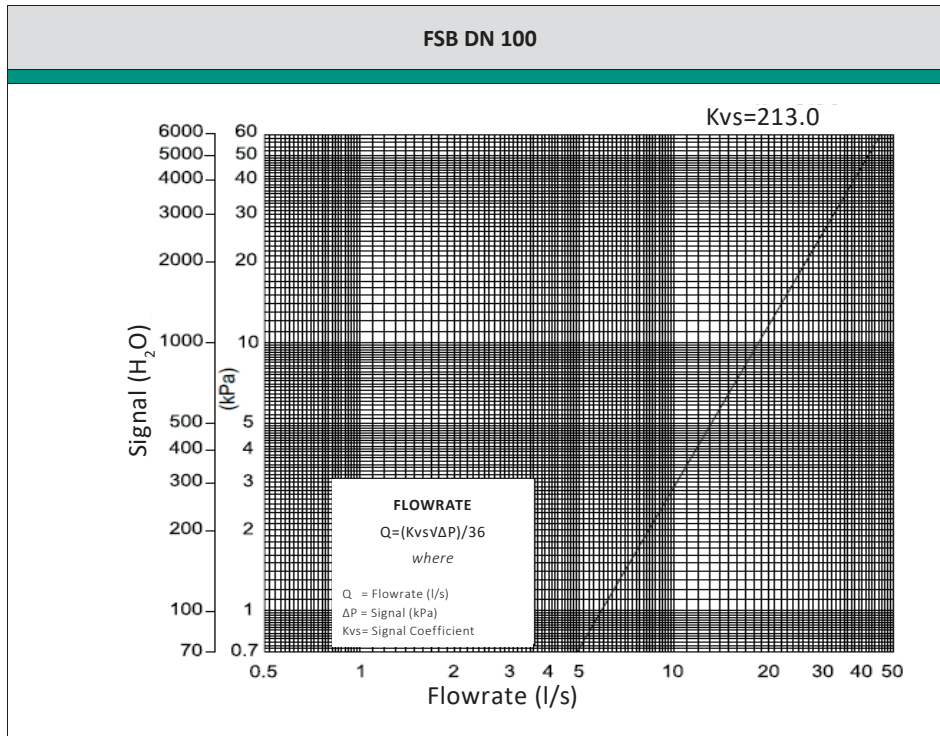

# FIVC Static Balancing Valve

Ductile Iron – PN 16 – Fixed Orifice – EN 1092-2

## Flow Measurement Graphs

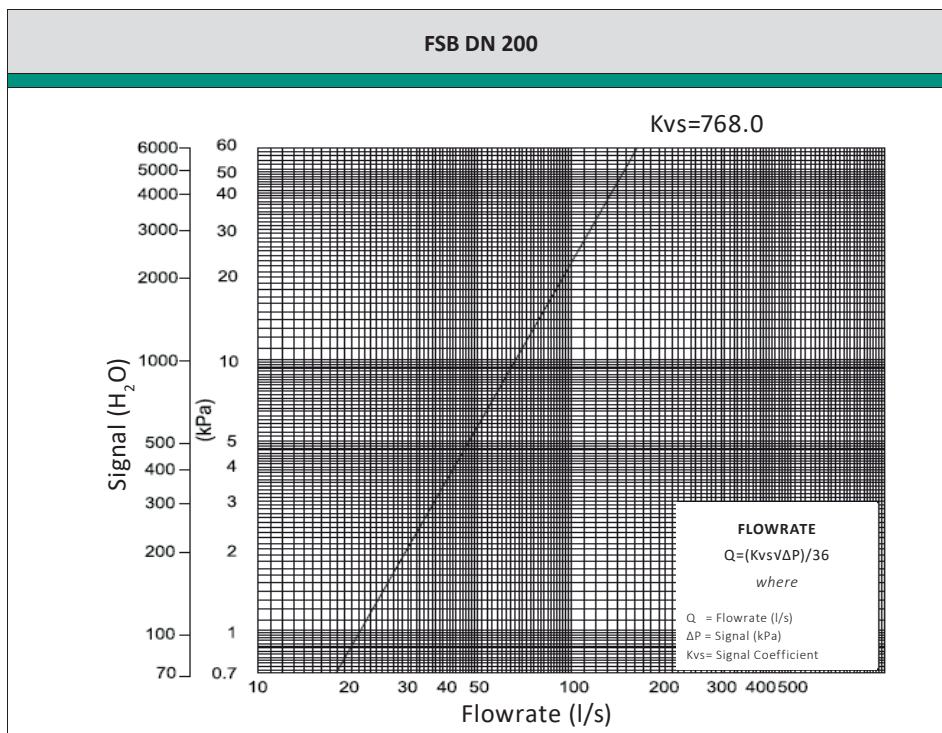
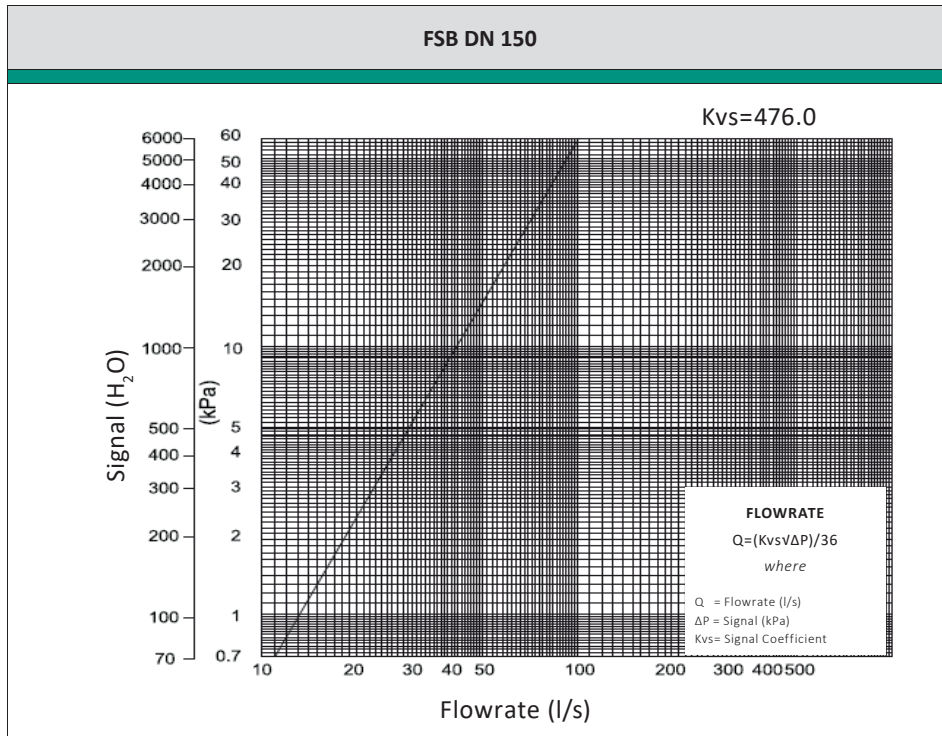

# FIVC Static Balancing Valve

Ductile Iron – PN 16 – Fixed Orifice – EN 1092-2

## Flow Measurement Graphs

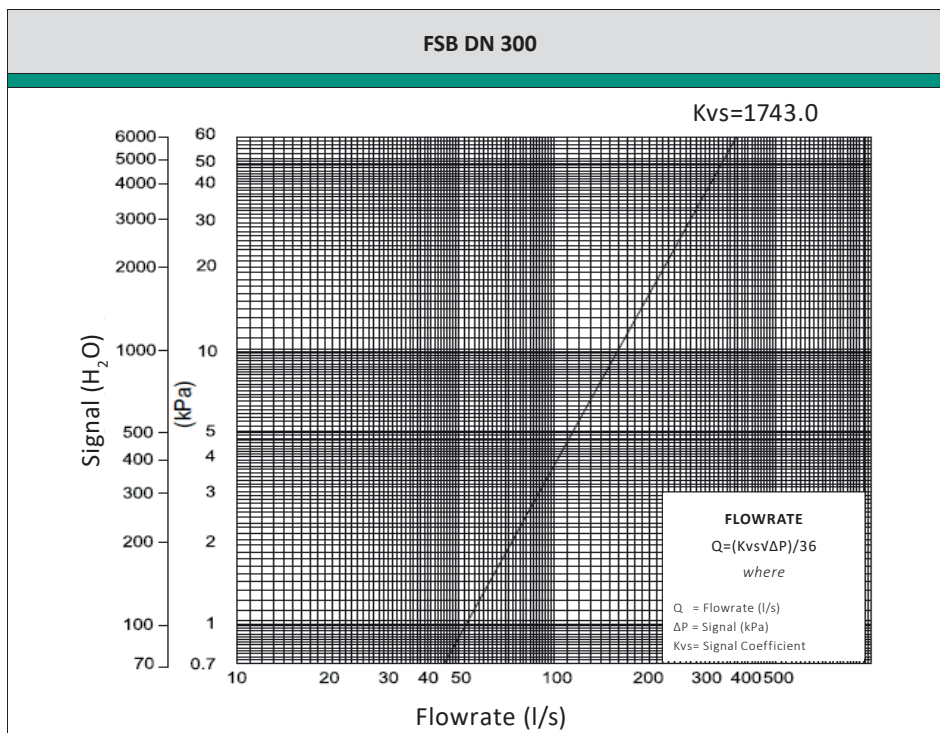
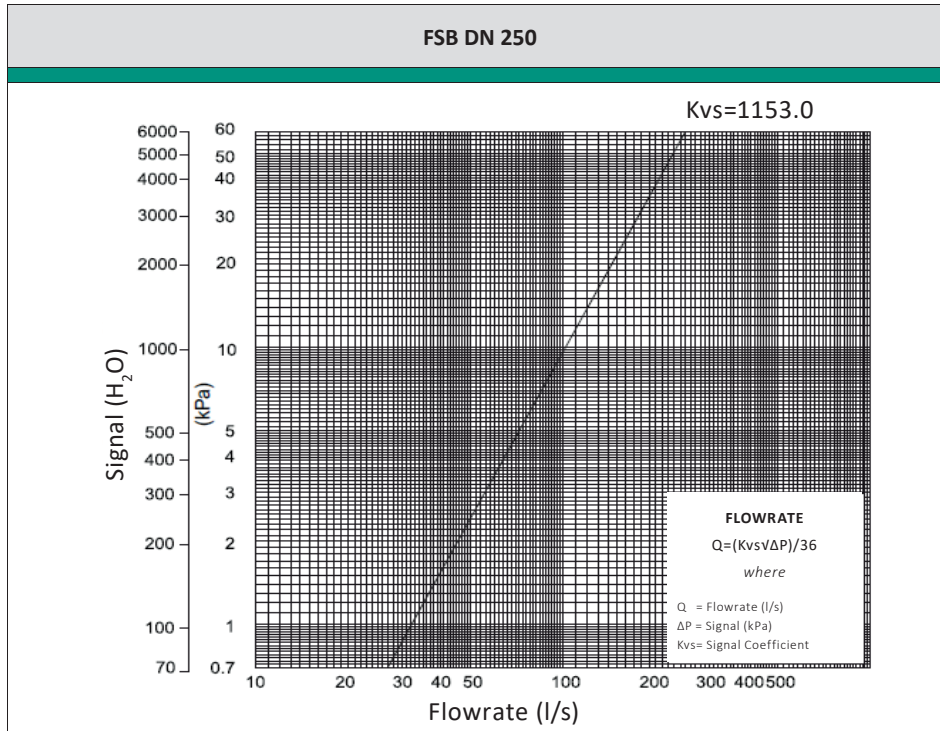

# FIVC Static Balancing Valve

Ductile Iron – PN 16 – Fixed Orifice – EN 1092-2

## Flow Measurement Graphs

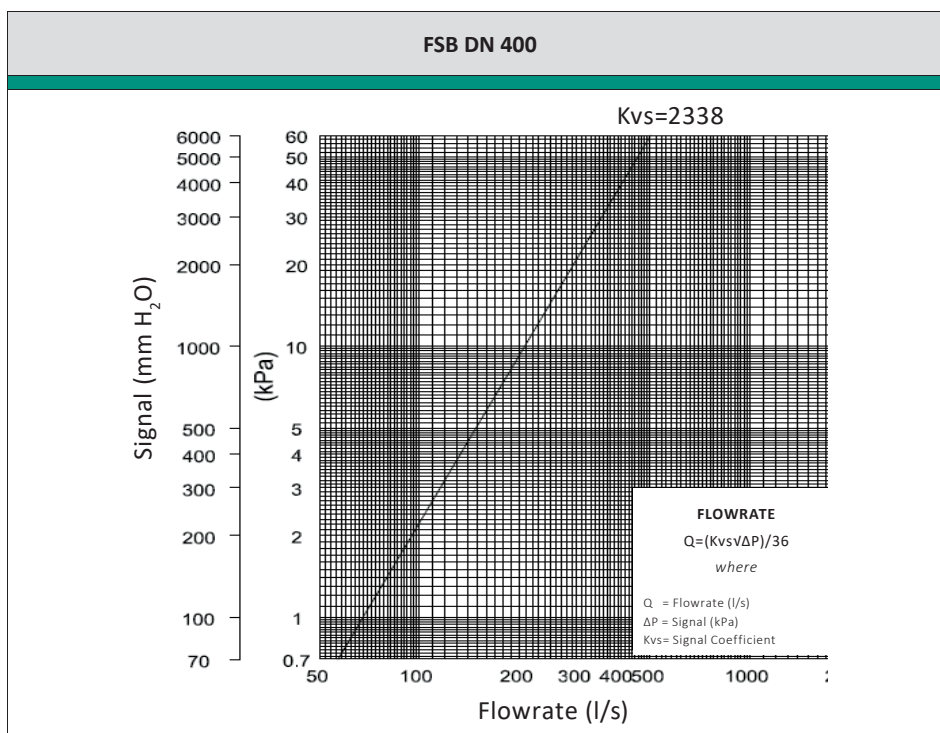
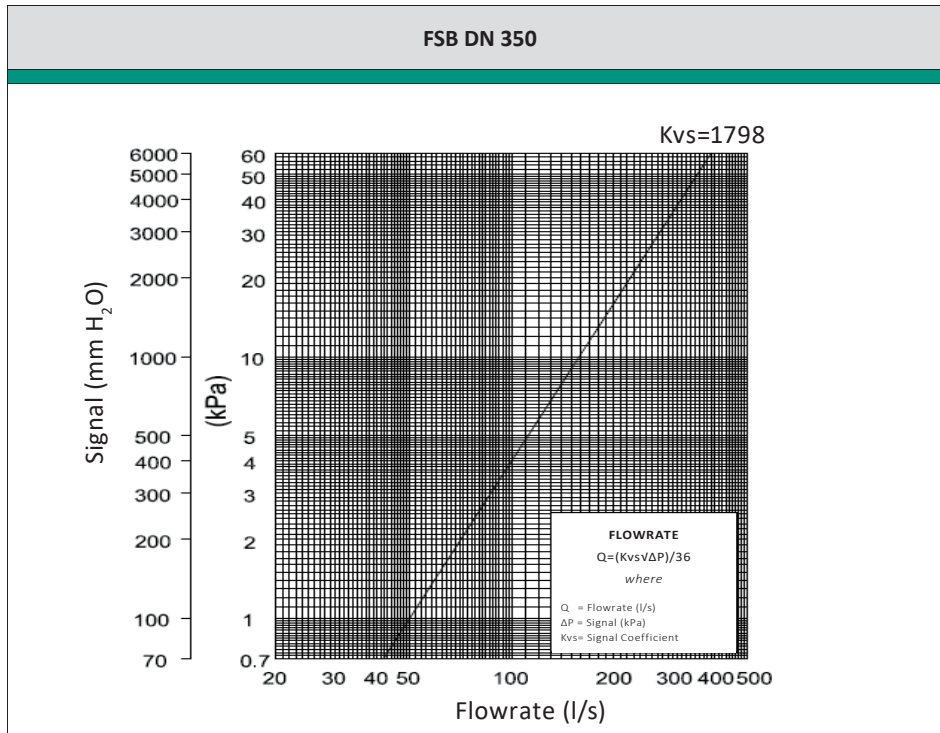

# FIVC Static Balancing Valve

Ductile Iron – PN 16 – Fixed Orifice – EN 1092-2

## Flow Measurement Graphs

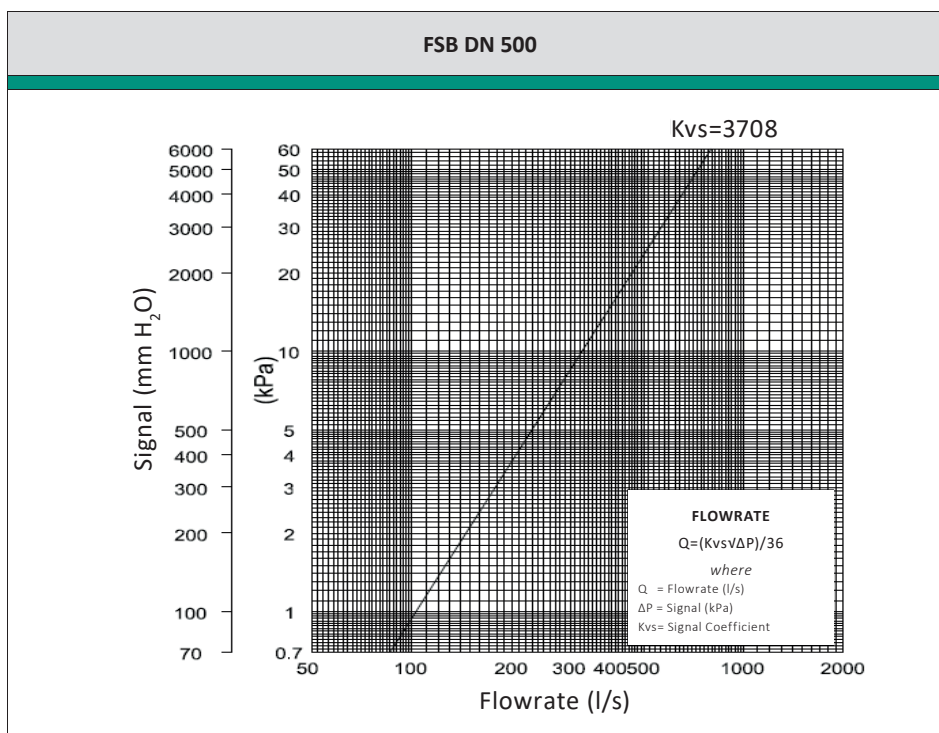
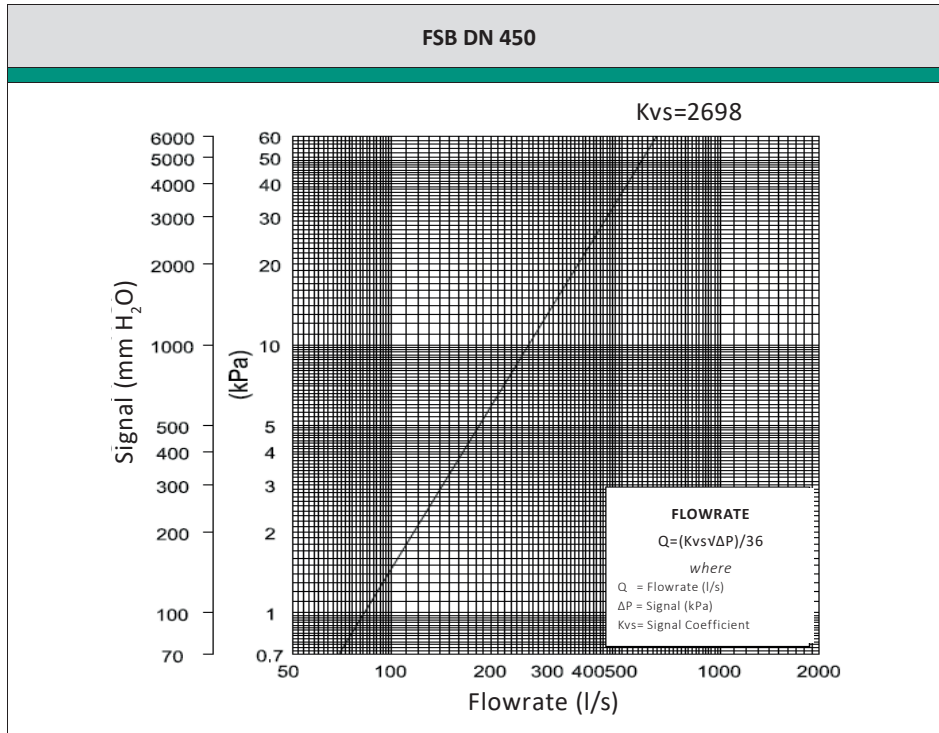



# FIVC Static Balancing Valve

Ductile Iron – PN 16 – Fixed Orifice – EN 1092-2

## Flow Measurement Graphs

