

# FIVC Motorized Globe Valve

Brass – PN 16 – ON-OFF – Full Port – ISO 228

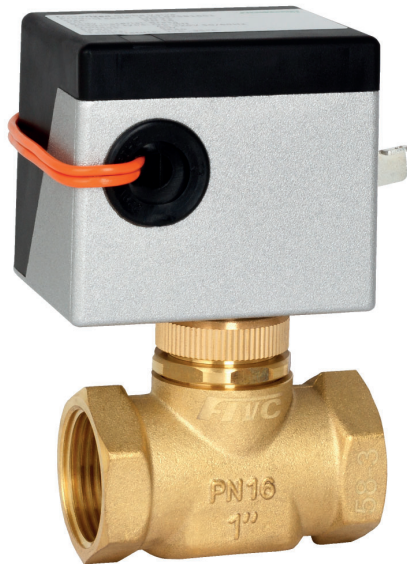

## Technical data

### Main features and materials

• Body:	Forged Brass
• Trim:	Forged Brass
• Seal:	Forged Brass
• O-Ring:	EPDM/NBR
• Shaft:	Stainless Steel
• Spring:	Stainless Steel
• Packing:	EPDM/NBR
• Actuator type:	ON-OFF actuator
• Voltage:	24V DC or 220V AC 50/60 Hz
• Power:	6 W
• IP class:	IP40
• Drive force:	196.2 N
• Stroke:	3 mm (max. 5 mm)
• Operating time:	Opening: ≤10 sec. Closing: ≤5 sec.
• Cable length:	50 cm
• USP:	Integrated failsafe Manual disc operation mode

### Field of applications

• Max. medium temperature:	1 to 95 °C
• Max. temperature of actuator:	100 °C
• Max. working pressure:	16 bar
• Max. closing pressure:	5 bar

- Industrial cold/hot water plants
- Refrigeration and air conditioning

F2GL series

## Description

FIVC Motorized Globe Valve is designed to control the flow by opening and closing through its reliable ON-OFF actuator.

The valve is commonly used in fan coil units, cooling ceilings or cooling/heating ends and is electrically connected with a room thermostat or temperature controller. The valve reacts by opening or closing to maintain temperature according to the temperature setpoint on the temperature controller.

Benefits are quick response time, reduced operating energy consumption, long lifespan, and ensured leakage tightness.

Besides, the valve has an intergrated failsafe that ensures immediate fluid stop to a specific location in case of power loss. The actuator includes an integrated clutch that enables operating the valve manually. The valve is suitable for water.

## Declaration

The product has been inspected and tested in accordance with the Sound Engineering Practice SEP. Acc. to the European PED Directive N° 2014/68/EU, dated 15/05/2014, the product is exempted from CE marking (Cf. Art. 4.3).

## Dimensions

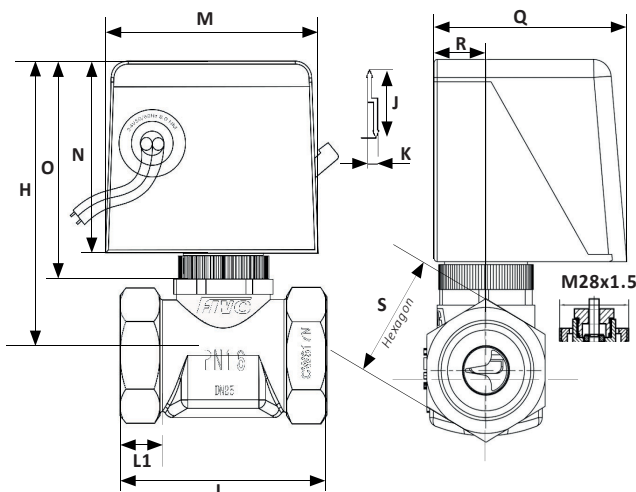

Product code	Size (DN)	L	L1	H	S	Kvs	Kg
F2GL015B1601	15	55	≥13	101	26	1.6	0.65
F2GL020B1601	20	60	≥13.5	104	31	2.5	0.68
F2GL025B1601	25	71	≥17	107	38	4.0	0.75

Dimensions are in millimeters

Actuator dimensions					J	K
M	N	O	Q	R		
74.8	62	75	65	17.5	30.2	5.2

Dimensions are in millimeters

# FIVC Motorized Globe Valve

Brass – PN 16 – ON-OFF – Full Port – ISO 228

## Product Specification

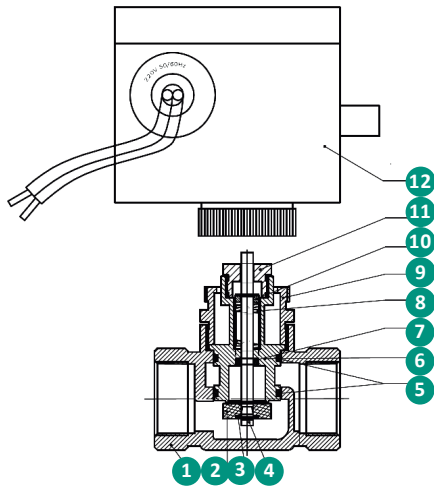

N°	Name	Material
1	Body	Forged Brass
2	Seal parts	Brass+Plastic
3	Ret. ring (E-type open)	Stainless Steel 304
4	Shaft	Stainless Steel
5	O-Ring	EPDM/NBR (ø21x1.8)
6	Cone	Forged Brass
7	Seal parts	EPDM/NBR
8	Spring	Stainless Steel 304
9	Joint	Forged Brass
10	Spring seat	Forged Brass
11	Cap	Forged Brass
12	Electrical actuator	-

## Wiring Diagram

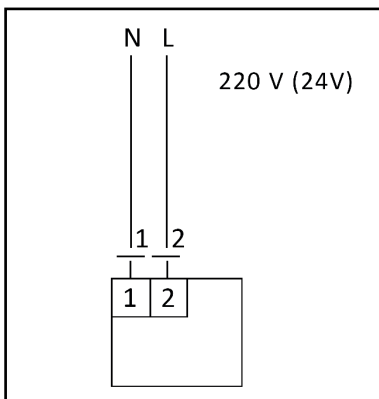

## Characteristics of control action

### ON/OFF control action

